



EXCEPTIONAL SUPPORT & PROTECTION™

PDT Series Thin Power Distribution



High density power strips feature a slim, low-profile design

Features

- Slim low-profile design requires minimum space
- Up to 20 outlets depending on model
- Lightweight aluminum chassis
- Field configurable single or dual circuits available in both 15 & 20 amp models
- Field configurable isolated ground models available
- Models available with remote notification of surge protection status
- Models available with local amp metering
- Mounting hardware included
- Corded models include 9' or 20' SignalSafe™ power cord terminated with NEMA 5-15P / 5-20P / L5-20P plug depending on model
- Black anodized finish
- Top feed models available
- ETL Listed in the US and Canada

* For additional Vertical Power Strips, please see A&E Spec # 96-938 and #96-976

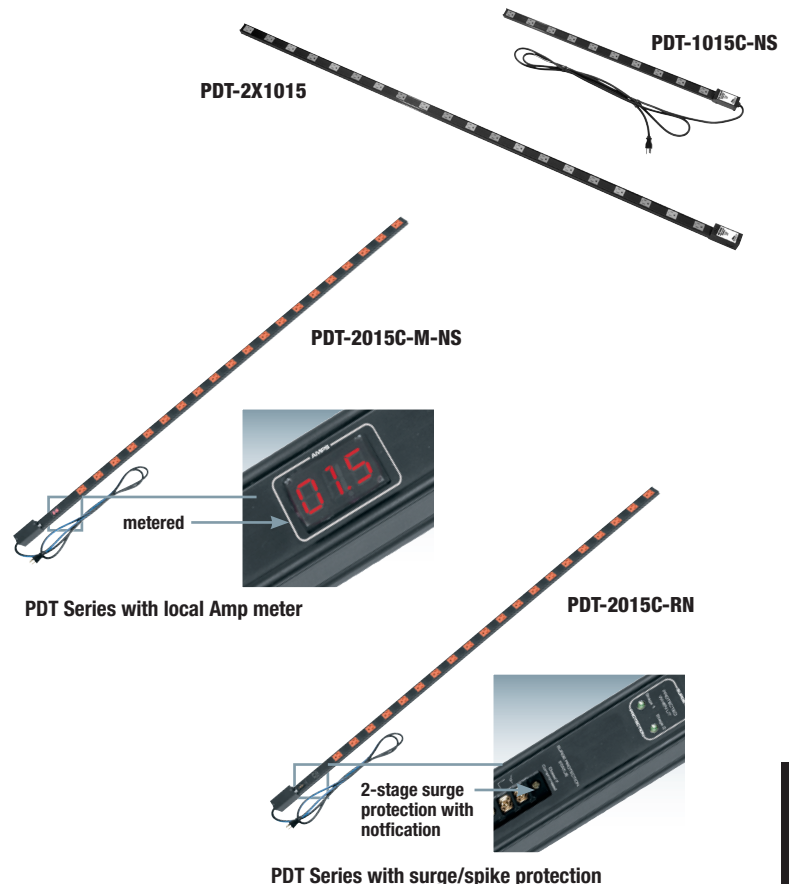

Architects' and Engineers' Specifications

High density thin power distribution shall be Middle Atlantic Products model # PDT-___ with ___ outlets and ___ amps (refer to chart). Thin power distribution shall be ___ long (refer to chart) x 1" deep x 1.9" (20 amp models) or 1.3" (15 amp models) wide. J-Box shall be 2.1" deep x ___" (refer to chart). Thin power distribution shall feature ___ NEMA 5-15R / 5-20R outlets (refer to chart). Corded power strip include ___ amp protection and mounting hardware (refer to chart). Corded models shall be terminated with 9' or 20' SignalSafe™ power cord and NEMA 5-15P / 5-20P / L5-20P plug (refer to chart). Thin power distribution shall be available with remote notification of surge protection (refer to chart). Thin power distribution shall be available with local amp metering (refer to chart). PDT Series shall feature a black anodized finish. Regular and top feed models shall be provided to accommodate installations where ground prongs must be positioned at the top of each outlet.

PDT Series with J-Box shall feature field configurable single or dual circuits available in both 15 & 20 amp models. PDT Series with J-Box shall feature field configurable isolated ground models. PDT shall include a permanently installed supplementary grounding and bonding stud. PDT Series shall be ETL listed to UL Standard 1363 in the US and to CAN/CSA C22.2 #21 in Canada. PDT shall be GREENGUARD Indoor Air Quality Certified for Children and Schools. PDT shall be RoHS EU Directive 2002/95/EC compliant. PDT shall be manufactured by an ISO 9001 registered company. PDT shall be warranted to be free from defects in material or workmanship under normal use and conditions for a period of three years.

CUSTOMIZABLE SPECIFICATION CLIPS AVAILABLE AT MIDDLEATLANTIC.COM

PDT Series 15 Amp basic dimensions

All dimensions in inches unless otherwise noted [All dimensions in brackets are in millimeters]

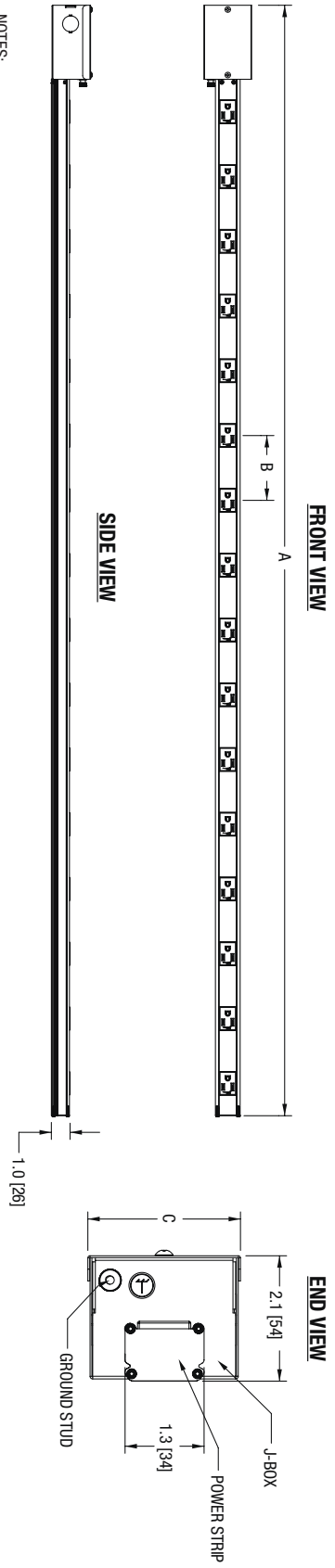

NOTES:
 1) ON CORDED MODELS ALLOW FOR A MINIMUM OF 2 [51] CORD BENDING SPACE
 2) PDT SERIES INCLUDE SIGNAL SAFE™ POWER CORD TECHNOLOGY

PART #	A OVERALL LENGTH	B OUTLET SPACING	C WIDTH	# OF OUTLETS	AMMETER	SURGE PROTECTION	CORD LENGTH/ TERMINATION	OUTLET TYPE	CIRCUIT	ISOLATED TECH- GROUND	OVERCURRENT PROTECTION	J-BOX/CORD LOCATION
PDT-615C	29.5 [749]	4.33 [110]	1.58 [40]	6	NONE	SINGLE STAGE	9' CORD w/NEMA 5-15P PLUG	5-15R	1	NO	CIRCUIT BREAKER	BOTTOM
PDT-615C-NS	29.5 [749]	4.33 [110]	1.58 [40]	6	NONE	NONE	9' CORD w/NEMA 5-15P PLUG	5-15R	1	NO	CIRCUIT BREAKER	BOTTOM
PDT-1015C-NS	37.71 [958]	3.50 [89]	1.58 [40]	10	NONE	NONE	9' CORD w/NEMA 5-15P PLUG	5-15R	1	NO	CIRCUIT BREAKER	BOTTOM
PDT-1015C-NS20	37.71 [958]	3.50 [89]	1.58 [40]	10	NONE	NONE	20' CORD w/NEMA 5-15P PLUG	5-15R	1	NO	CIRCUIT BREAKER	BOTTOM
PDT-1015C-RN	37.75 [959]	2.62 [67]	1.58 [40]	10	NONE	2 STAGE SURGE w/STATUS NOTIFICATION	9' CORD w/NEMA 5-15P PLUG	5-15R	1	NO	CIRCUIT BREAKER	BOTTOM
PDT-1015C-M-NS	37.75 [959]	2.62 [67]	1.58 [40]	10	YES	NONE	9' CORD w/NEMA 5-15P PLUG	5-15R	1	NO	CIRCUIT BREAKER	BOTTOM
PDT-2X615S	30.00 [762]	2.14 [55]	2.58 [66]	12	NONE	SINGLE STAGE	J-BOX	5-15R	1 OR 2 (FIELD CONFIG)	FIELD CONFIG	NONE	BOTTOM
PDT-1415C	59.5 [1511]	4.00 [102]	1.58 [40]	14	NONE	SINGLE STAGE	9' CORD w/NEMA 5-15P PLUG	5-15R	1	NO	CIRCUIT BREAKER	BOTTOM
PDT-1415C-NS	59.5 [1511]	4.00 [102]	1.58 [40]	14	NONE	NONE	9' CORD w/NEMA 5-15P PLUG	5-15R	1	NO	CIRCUIT BREAKER	BOTTOM
PDT-1615C-NS	33.50 [851]	1.82 [46]	1.58 [40]	16	NONE	NONE	9' CORD w/NEMA 5-15P PLUG	5-15R	1	NO	CIRCUIT BREAKER	BOTTOM
PDT-2X815	60.00 [1524]	3.50 [89]	2.58 [66]	16	NONE	NONE	J-BOX	5-15R	1 OR 2 (FIELD CONFIG)	FIELD CONFIG	NONE	BOTTOM
PDT-2015C-M-NS	72.72 [1847]	3.09 [79]	1.58 [40]	20	YES	NONE	9' CORD w/NEMA 5-15P PLUG	5-15R	1	NO	CIRCUIT BREAKER	BOTTOM
PDT-2015C-RN	72.72 [1847]	3.09 [79]	1.58 [40]	20	NONE	2 STAGE SURGE w/STATUS NOTIFICATION	9' CORD w/NEMA 5-15P PLUG	5-15R	1	NO	CIRCUIT BREAKER	BOTTOM
PDT-2015C-NS	72.72 [1847]	3.50 [89]	1.58 [40]	20	NONE	NONE	9' CORD w/NEMA 5-15P PLUG	5-15R	1	NO	CIRCUIT BREAKER	BOTTOM
PDT-2X1015	73.25 [1861]	3.50 [89]	2.58 [66]	20	NONE	NONE	J-BOX	5-15R	1 OR 2 (FIELD CONFIG)	FIELD CONFIG	NONE	BOTTOM
PDT-2X1015T	73.25 [1861]	3.50 [89]	2.58 [66]	20	NONE	NONE	J-BOX	5-15R	1 OR 2 (FIELD CONFIG)	FIELD CONFIG	NONE	TOP

PDT Series 20 Amp basic dimensions

All dimensions in inches unless otherwise noted [All dimensions in brackets are in millimeters]

FRONT VIEW

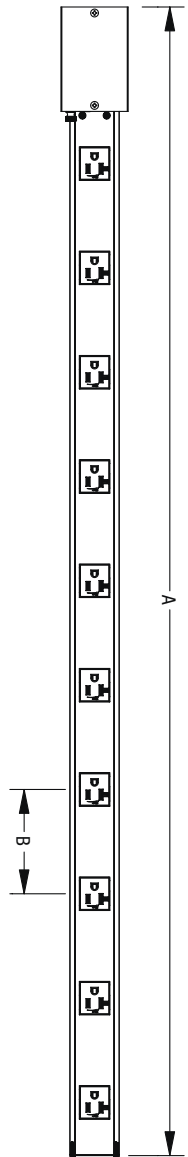

SIDE VIEW

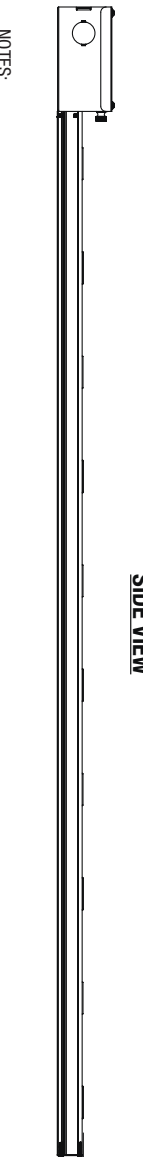

END VIEW

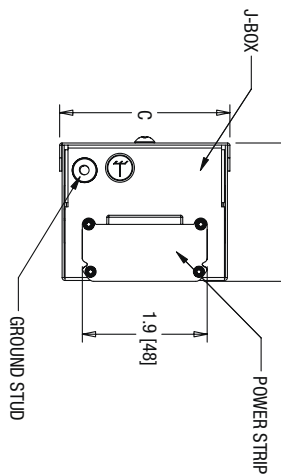

- NOTES:
 1) ON CORDED MODELS ALLOW FOR A MINIMUM OF 2 [51] CORD BENDING SPACE
 2) PDT SERIES INCLUDE SIGNALSAFE™ POWER CORD TECHNOLOGY

PART #	A OVERALL LENGTH	B OUTLET SPACING	C WIDTH	# OF OUTLETS	AMMETER	SURGE PROTECTION	CORD LENGTH/ TERMINATION	OUTLET TYPE	CIRCUIT	ISOLATED TECH.GROUND	OVERCURRENT PROTECTION	J-BOX/CORD LOCATION
PDT-620C-NS	29.5 [749]	4.33 [110]	2.13 [54]	6	NONE	NONE	9' CORD w/NEMA 5-20P PLUG	5-20R	1	NO	CIRCUIT BREAKER	BOTTOM
PDT-2X320	30.00 [762]	4.33 [110]	2.58 [66]	6	NONE	NONE	J-BOX	5-20R	1 OR 2 (FIELD CONFIG)	FIELD CONFIG	NONE	BOTTOM
PDT-2X520	44.00 [1118]	4.00 [102]	2.58 [66]	10	NONE	NONE	J-BOX	5-20R	1 OR 2 (FIELD CONFIG)	FIELD CONFIG	NONE	BOTTOM
PDT-1020C-NS	37.75 [959]	3.50 [89]	2.13 [54]	10	NONE	NONE	9' CORD w/NEMA 5-20P PLUG	5-20R	1	NO	CIRCUIT BREAKER	BOTTOM
PDT-1220C-NS	59.5 [1511]	4.66 [118]	2.13 [54]	12	NONE	NONE	9' CORD w/NEMA 5-20P PLUG	5-20R	1	NO	CIRCUIT BREAKER	BOTTOM
PDT-2X820	60.00 [1524]	3.5 [89]	2.58 [66]	16	NONE	NONE	J-BOX	5-20R	1 OR 2 (FIELD CONFIG)	FIELD CONFIG	NONE	BOTTOM
PDT-1620C-NS	33.5 [851]	1.82 [46]	2.13 [54]	16	NONE	NONE	9' CORD w/NEMA 5-20P PLUG	5-20R	1	NO	CIRCUIT BREAKER	BOTTOM
PDT-2020C-NS	72.75 [1848]	3.50 [89]	2.13 [54]	20	NONE	NONE	9' CORD w/NEMA 5-20P PLUG	5-20R	1	NO	CIRCUIT BREAKER	BOTTOM
PDT-2020C-RN	72.75 [1848]	3.09 [79]	2.13 [54]	20	NONE	2 STAGE SURGE w/STATUS NOTIFICATION	9' CORD w/NEMA 5-20P PLUG	5-20R	1	NO	CIRCUIT BREAKER	BOTTOM
PDT-2020C-M-NS	72.75 [1848]	3.09 [79]	2.13 [54]	20	YES	NONE	9' CORD w/NEMA 5-20P PLUG	5-20R	1	NO	CIRCUIT BREAKER	BOTTOM
PDT-2020TL-NS	72.75 [1848]	3.50 [89]	2.13 [54]	20	NONE	NONE	9' CORD w/NEMA 5-20P PLUG	5-20R	1	NO	CIRCUIT BREAKER	BOTTOM
PDT-2020TL-M-NS	72.75 [1848]	3.09 [79]	2.13 [54]	20	YES	NONE	9' CORD w/NEMA 5-20P PLUG	5-20R	1	NO	CIRCUIT BREAKER	BOTTOM
PDT-2X1020	73.25 [1861]	3.50 [89]	2.58 [66]	20	NONE	NONE	J-BOX	5-20R	1 OR 2 (FIELD CONFIG)	FIELD CONFIG	NONE	BOTTOM
PDT-2X1020T	73.25 [1861]	3.50 [89]	2.58 [66]	20	NONE	NONE	J-BOX	5-20R	1 OR 2 (FIELD CONFIG)	FIELD CONFIG	NONE	TOP

